



STARTING SCHOOL

Contact Us:



(02) 9560 2208



<https://marrickvil-p.schools.nsw.gov.au/>



116 Chapel St Marrickville NSW 2204





CONTENTS



- 03 [Connection to Country and Acknowledgement](#)
- 05 [About Our School](#)
- 08 [School Bell Times and Hours of Operation](#)
- 09 [Find Us and Our Grounds](#)
- 10 [School Uniform Information](#)
- 11 [Best Start Assessment Information for Parents and Families](#)
- 12 [YMCA Out of School Hours Care Information for Parents and Families](#)
- 13 [Eating at School](#)
- 15 [Our STEM Lab](#)
- 16 [Extra Curricular Sport](#)
- 17 [Music and Performance at MPS](#)
- 18 [Extra Curricular Activities](#)
- 19 [Preparing Your Child for Kindergarten](#)
- 21 [School Canteen](#)
- 25 [Parents and Citizen's Association](#)
- 26 [Wellbeing Information](#)
- 27 [Learning and Curriculum](#)

CONNECTION TO COUNTRY

Our school and community prides itself on our deep connection to country. Aboriginal and Torres Strait Islander peoples were the first people to live on this Country. They have been here for tens of thousands of years. Our school is built on Cadigal and Bulanamming land and we respect and honour the teaching and learning that has taken place on this land for thousands of years.



ACKNOWLEDGEMENT



We would like to acknowledge the traditional owners and custodians of this land, the Gadigal peoples of the Eora nation. We appreciate the waterways, mountains, sky, plants and animals from this place.

We acknowledge our ancestors and elders, those before us, with us and those to come, thanking them for their teachings and knowledge.

We recognise our special connection to this land and dreaming through our dance, song, taste, touch and dreams.

We respect the spiritual systems of our people and walk gently together across this country.

Written by our First Nation students in consultation with our community Elders, 2018

ABOUT US



Marrickville Public School is committed to providing quality primary education that inspires and empowers young learners. With dedicated staff who are passionate about teaching and creating a supportive learning environment, students are encouraged to thrive academically, socially, and emotionally. The school values the importance of our vibrant community and offers a range of extra-curricular activities to foster creativity, teamwork, and leadership skills. Students at Marrickville Public School receive a well-rounded education that prepares them for success in the future.

WHAT DO WE DO?

- We are a government primary school providing education for children in years K - 6.
- We are proud of our connection to the land, First Nations people and the vibrant community of the Inner West of Sydney.

1864

OVER 150 YEARS

Our school celebrated 150 years of Public Education in 2014. Much has changed over the years!

FIND US

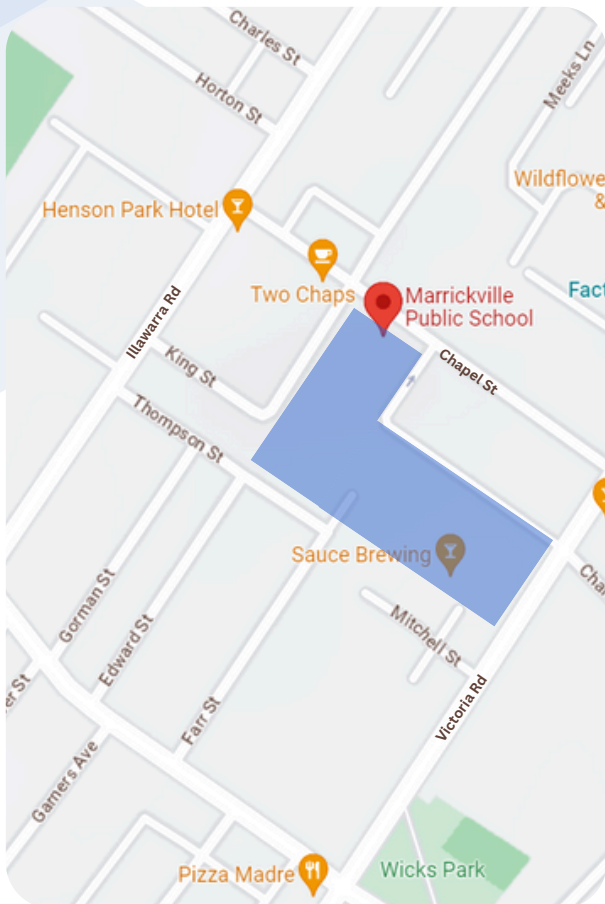

Located in the heart of the Inner West and surrounded by vibrant cafes, parks and amenities, Marrickville Public School is at the heart of our diverse local community. Main entry to the school is through Chapel St and Thompson St.



HOW TO ENROL

Enrolment in a government school can now be completed online.

- Go to the school website
- Click on Enrolment to start the process

Our of Area Enrolments

Follow the same process and when prompted you will need to provide additional information about your reasons for applying to an out of area school.

School Finder

<https://schoolfinder.education.nsw.gov.au/>

Enter your address and see your catchment area.

MAKE A PAYMENT | **ENROLMENT** | NEWS | NEWSLETTER



Marrickville Public School

Achieve Create Inspire

T: 02 9560 2208

E: marrickvil-p.school@det.nsw.edu.au

About our
school

Supporting our
students

Learning at our
school

Create at our
school

Inspire at our
school

Contact us

Sen
por





OUR GROUNDS

Thompson St

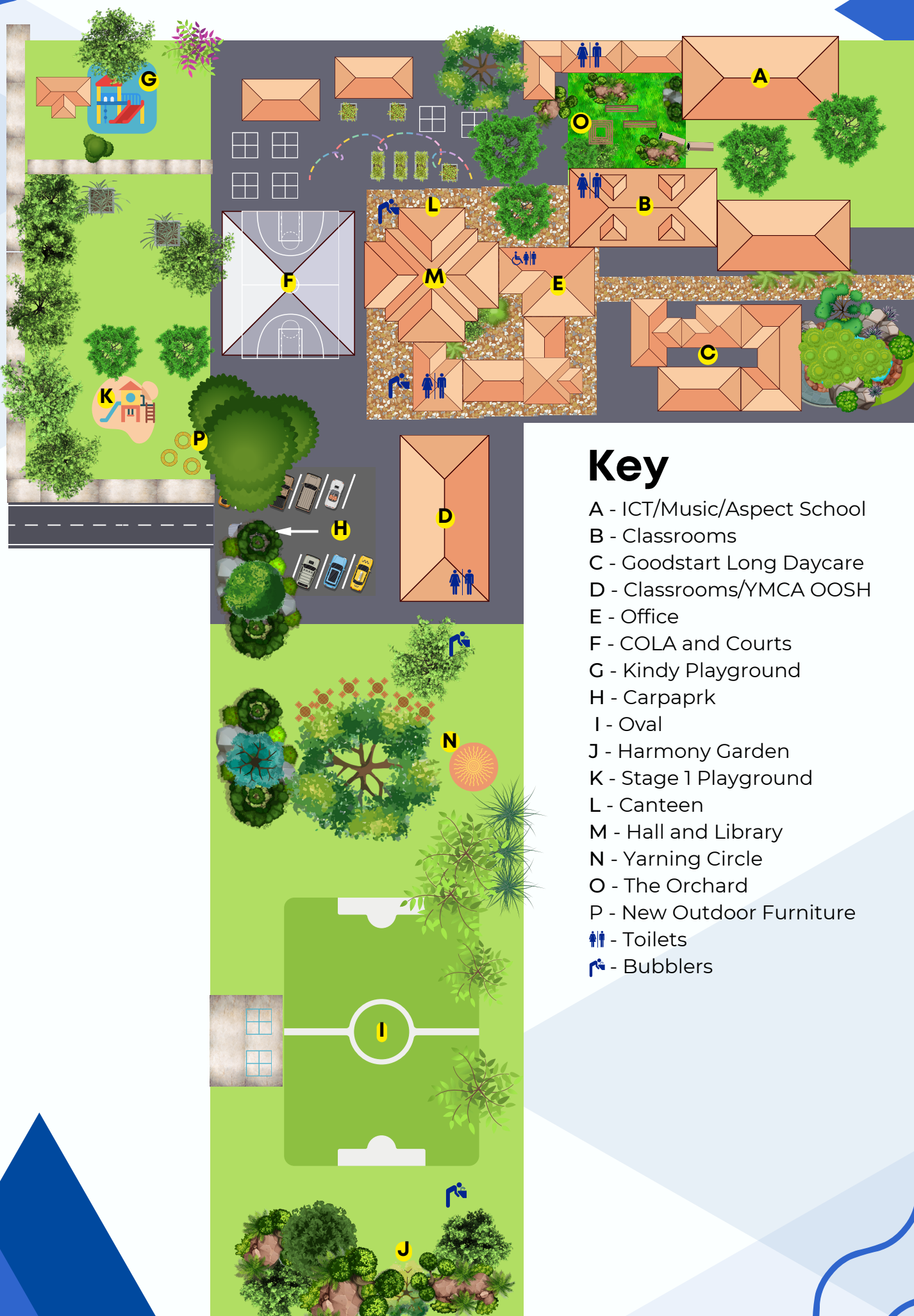
Chapel St



Key

- A - ICT/Music/Aspect School
- B - Classrooms
- C - Goodstart Long Daycare
- D - Classrooms/YMCA OOSH
- E - Office
- F - COLA and Courts
- G - Kindy Playground
- H - Carpark
- I - Oval
- J - Harmony Garden
- K - Stage 1 Playground
- L - Canteen
- M - Hall and Library
- N - Yarning Circle
- O - The Orchard
- P - New Outdoor Furniture
-  - Toilets
-  - Bubblers



SCHOOL BELL TIMES



School Operating Hours

7:00 YMCA OOSH opens for Before School Care

8:30 Ensembles rehearsals and sports training.

9:10 Morning Bell for all students

11:05 Lunch – eating time for all students

11:15 Lunch – playtime

11:55 Middle learning session

1:55 Recess

2:15 Afternoon learning session

3:15 End of school day for all students

6:00 YMCA After School Care runs from 3:15 – 6:00

WELLBEING

At our core, we value 'Be Safe', 'Be Respectful' and 'Be a Learner' as the foundation of wellbeing. By prioritising safety, respect, and learning, we create an environment that fosters resilience and a growth mindset. We believe that by being safe, we can create a sense of security that allows us to take risks and grow. By being respectful, we create a culture of support and kindness, which nurtures our sense of belonging. And by being a learner, we are open to new ideas and perspectives, which allows us to adapt and thrive in any situation. Together, these values help us build resilience and a growth mindset, empowering us to overcome challenges and achieve our goals.



Life Skills Go

Life Skills GO, designed in collaboration with educators, is an easy-to-use emotion and wellbeing data collection tool that measures student readiness to learn, supported with a comprehensive library of evidence-based and curriculum aligned resources

Grow Your Mind



All students are supported in their mental health and emotional wellbeing through the Grow Your Mind program at MPS. Grow Your Mind builds resilience and supports respectful relationships and consent education. Grow Your Mind is available as a quality-assured program in the NSW Department of Education's Student Wellbeing external programs catalogue.

OUR VALUES

Be Safe
Be Respectful
Be a Learner



Meet Waddles the penguin! He promotes positive behaviours and collaboration. Students earn positive reinforcement tokens that build towards personal and whole class rewards.



Student leadership is promoted through our Year 6 Buddy Program, Leadership Camp, School Captains, Sports Captains, and Student Representative Council.

CURRICULUM

Kindergarten to Year 6 includes four Stages of learning:

- Early Stage 1 – Kindergarten
- Stage 1 – Year 1 and Year 2
- Stage 2 – Year 3 and Year 4
- Stage 3 – Year 5 and Year 6

Time allocation guide for key learning areas

The NSW Education Standards Authority (NESA) provides the following as a guide for K–6 time allocations.

The allocation for 'additional activities' provides flexibility for schools to incorporate activities reflective of their context and ethos. We use this time to incorporate assemblies, scripture, school sport and special whole school events.

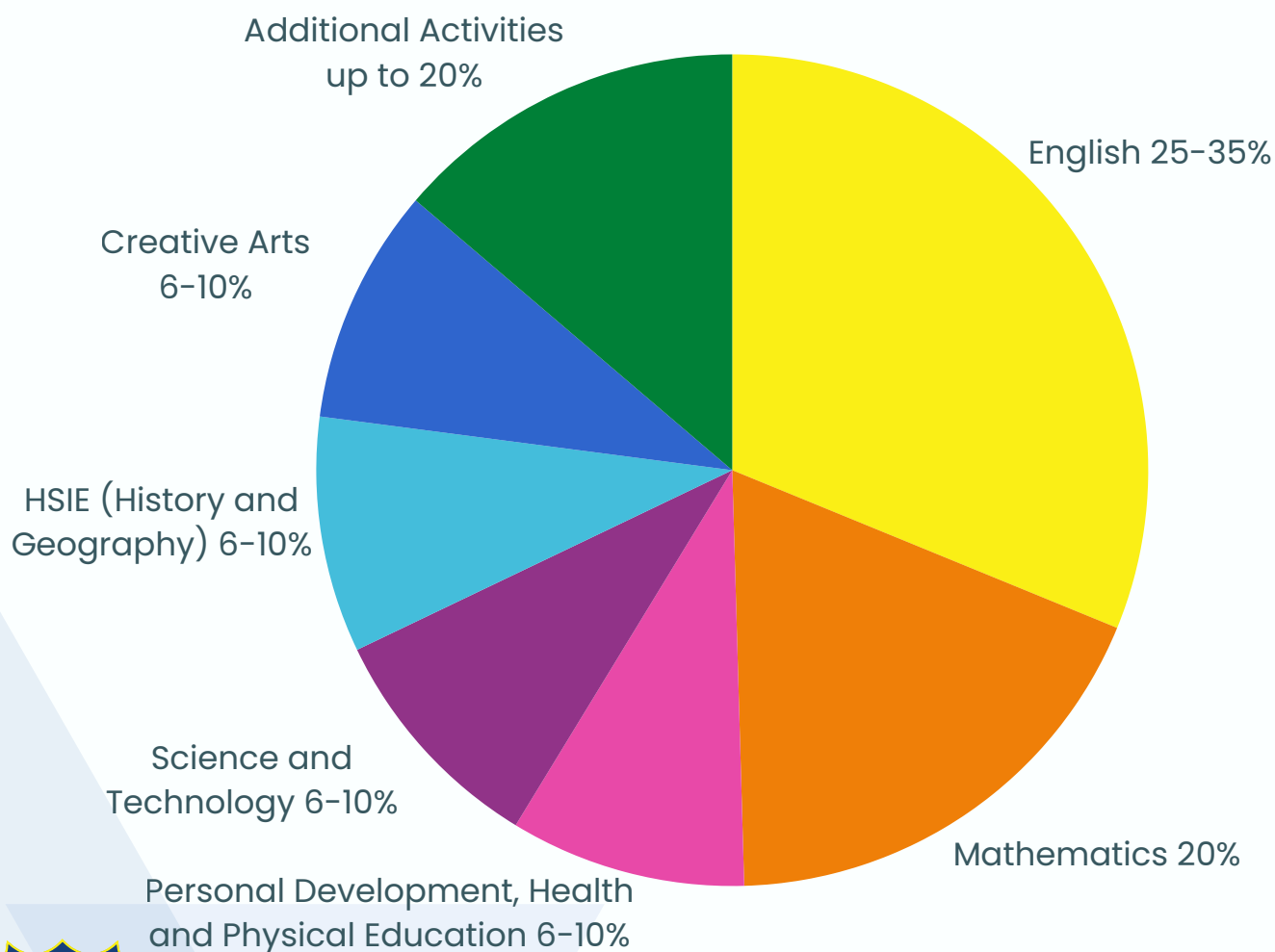

6–10% is approximately 1.5 to 2.5 hours in a typical teaching week.



SUPPORTING LEARNING AT HOME

The NSW Department of Education has a number of resources to support learning at home from early on in a child's development. Access these resources to view a wide range of activities that can become part of your family routines and promote learning as fun, engaging and part of everyday life. (Links will take you to the NSW Department of Education website)

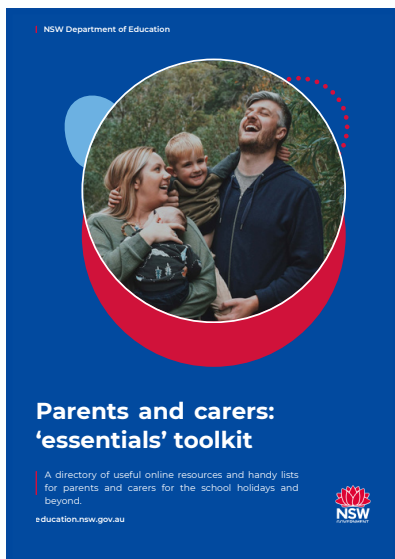

PICKLES.SCHOOLWEAR SINCE 1976

Marrickville Public School CATALOGUE

Please check online for current price lists.



Summer Uniform



Winter Uniform



Outerwear



Accessories



1. Summer Check Dress **2.** Girls Skort **3.** Boys Shorts **6.** Girls Winter Pants **7.** Unisex Fleece Trackpants **8.** Unisex Zip Fleece Jacket **9.** Unisex Fleece Sweatshirt **12.** Girls Royal Netball Skirt **13.** Unisex Royal Sport Short **14.** Backpack **15.** Library Bag **16.** School Cap **17.** Bucket Hat **18.** Slouch Hat **19.** 3 Pack White Socks **20.** Girls Navy Tights **21.** Hair Accessories

Shop Online www.picklesschoolwear.com





Marrickville Public School

PRICE LIST 2024 - 2025

PICKLES
SCHOOLWEAR SINCE 1976

SUMMER UNIFORM	SIZES	PRICE	ACCESSORIES	SIZES	PRICE
GIRLS SUMMER CHECK DRESS	4, 6, 8, 10	\$58.50	BACKPACK + EMBLEM	ONE SIZE	\$58.50
	12, 14, 16	\$59.50	LIBRARY BAG + EMBLEM	ONE SIZE	\$15.00
UNISEX GOLD SHORT SLEEVE POLO + EMBLEM	4, 6, 8, 10, 12, 14, 16, 18, 20	\$5.00	ROYAL BUCKET HAT + EMBLEM	XS/S, S/M, M/L	\$19.50
			ROYAL CAP + EMBLEM	ONE SIZE	\$18.50
BOYS ROYAL RUGBY KNIT SHORTS WITH ZIP POCKET	4, 5, 6, 8, 10, 12, 14, 16, 18, 20, 22	\$27.50	WHITE SOCKS - 3 PACK	5-8, 9-12, 13-3, 2-8	\$15.00
			NAVY COTTON TIGHTS - 2 PACK	3-5, 6-9, 10-12, M, L, XL, XXL	\$22.50
GIRLS ROYAL SKORT WITH ADJUSTABLE WAIST	4, 6, 8, 10	\$36.50	NAVY OPAQUE TIGHTS - 2 PACK	6-9, 10-12, MIDS	\$17.50
	12, 14, 16, 18, 20	\$37.50			
WINTER UNIFORM	SIZES	PRICE	SATIN BOWS: GOLD, ROYAL, WHITE	ONE SIZE	\$6.50
UNISEX GOLD LONG SLEEVE POLO + EMBLEM	4, 5, 6, 8, 10, 12, 14, 16, 18, 20	\$10.00	ALICE HEADBANDS	NARROW	\$10.00
				WIDE	\$10.00
UNISEX ROYAL STRAIGHT LEG TRACK PANTS	4, 5, 6, 8, 10	\$32.50	SCRUNCHIES: SUMMER CHECK, SATIN (ROYAL, GOLD)	ONE SIZE	\$6.00
	12, 14, 16	\$35.00			
GIRLS TRACK AND FIELD PANTS	4, 6, 8, 10	\$35.00	<div>SHOP LOCATION</div> <p>Uniforms are available exclusively through the Pickles Marrickville Retail Outlet at the corner of Fitzroy St &, Saywell St, Marrickville or online.</p> <div>OPENING HOURS</div> <p>For up to date opening hours please go to the Pickles website and select your school from the SHOP ONLINE SCHOOLS drop down menu.</p> <div>DELIVERY AND SHIPPING INFORMATION</div> <p>Please allow up to 7 working days for order processing. Delays may occur during peak periods or due to temporary stock shortages.</p> <p>Online orders may be:</p> <ul style="list-style-type: none">Delivered free to school during term timeDelivered to a nominated address for \$12.50Collect from our Pickles Marrickville Retail Outlet <p>Prices valid from 1 Oct 2024 to 30 Sept 2025</p>		
	12, 14, 16, 18	\$37.50			
UNISEX ROYAL & GOLD BOMBER JACKET + EMBLEM	4, 5, 6, 8, 10, 12, 14, 16, 18, 20, 22	\$49.50			
UNISEX ROYAL SWEATSHIRT + EMBLEM	4, 6, 8, 10, 12, 14, 16	\$37.50			
SPORTS UNIFORM	SIZES	PRICE			
UNISEX MPS SPORTS POLO + EMBLEM	4, 6, 8, 10, 12, 14, 16, 18, 20	\$37.50			
GIRLS ROYAL NETBALL SPORT SKIRT	4, 6, 8, 10, 12, 14, 16	\$30.00			
UNISEX ROYAL MICROFIBRE SPORTS SHORTS	4, 6, 8, 10, 12, 14, 16, 18, 20, 22	\$27.50			
GIRLS BIKE SHORTS	4, 6, 8, 10, 12, 14, 16	\$13.50			

Purchase your uniforms at www.picklesschoolwear.com



BEST START KINDERGARTEN ASSESSMENT



Best Start Kindergarten Assessment identifies student's literacy and numeracy skills on entry to Kindergarten. It has been conducted in all NSW public schools since 2010. The assessment is mapped to the National Literacy and Numeracy Learning Progressions.

The assessment is conducted in line with existing school practices and builds upon teaching and learning programs that support students in the transition to school.

In 2023 there were changes to items in both the literacy and numeracy components of the Best Start Kindergarten Assessment and the online recording tool. These changes are to ensure the assessment aligns to Version 3 of the National Literacy and Numeracy Learning Progressions and new English and Mathematics K-2 syllabuses.

The Best Start Assessment will be administered by classroom teachers during the first five weeks of Kindergarten.

The "What is the Best Start Kindergarten Assessment?" video provides parents and carers with an overview of the assessment.

FIND OUT MORE



The NSW Department of
Education's guide for parents.



OUT OF HOURS SCHOOL CARE



The Y Marrickville OSHC is part of the Y NSW's extensive network of Outside School Hours Care services. YMCA OSHC provide safe and enjoyable experiences for the children they care for.

Families can apply to Centrelink for the Child Care Subsidy which can be applied to all fees for Out of Hours Care.

Before School Care

Monday – Friday
7:00 am to 9:15 am

After School Care

Monday – Friday
3:00 pm to 6:00 pm

Vacation Care

Monday – Friday
7:00 am to 6:00 pm

FIND OUT MORE



Enquire and enrol at YMCA
Marrickville Public School OSHC



EATING AT SCHOOL



LUNCH

11:05 – 11:55

11:05 – 11:15 is supervised eating time for all students. We love nude food where possible and encourage students to be independent with their food.



RECESS

1:55 – 2:15

Recess is a shorter break and a quick, hand-held snack is often best.

REFILLABLE WATER BOTTLE



CRUNCH AND SIP

A mid-learning break

A quick, healthy fruit and veggie snack along with some water to provide our brains with a boost to keep on learning.



STEM LAB



Digital Design and Problem Solving

STEM in schools refers to the integration of science, technology, engineering, and mathematics into the curriculum. It aims to develop students' critical thinking, problem-solving, and analytical skills through hands-on, project-based learning. STEM education is becoming increasingly important due to the growing demand for jobs in these fields and the need to prepare students for a rapidly evolving technological landscape.

STEM at School

All students from Kindergarten through to Year 6 access the STEM Lab every week through our rich, hands-on curriculum.

STEM in the Classroom



Collaboration

Students work collaboratively using the design process to develop solution prototypes.



Digital Skills and Coding

Students develop their ICT skills through coding challenges to create games, videos and more.



Real-World Problem Solving

Students become engineers as they work to solve real problems at school and across the world.



Applied Skills

Students apply their mathematical understanding to solve problems.



MUSIC AT MPS



Musical Maestros

There are a wide range of musical options for students at Marrickville Public School that can be accessed in class, in school hours and outside of school hours.

Our music tutors are passionate and highly accomplished in their fields of expertise.

Why Choose Us?

From budding flautists to accomplished violinists, there is something for everyone in our Music Education Programs and Extra Curricular Activities.

Inclusive and Accessible Music Education



Concert Band



Our enthusiastic concert band is lead by Bennelong Music offering tuition in a wide range of instruments.
<https://www.bennelongmusic.com.au/>



Recorder Ensembles

From Rookie Recorders to established practitioners, students can access and learn this beloved woodwind instrument for all abilities.



String Ensembles

New and continuing students in violin, viola and cello. Tuition is also available on site.



Choral Ensembles

Our students rehearse and perform in both the Cantabile Music Festivals and the Primary Proms every year.



EXTRA CURRICULAR ACTIVITIES

Clubs and Activities



Our school offers a range of additional clubs and groups based on students interest. These include opportunities such as our Rock Band, Ukelele group, Gardening Programs and Dungeons and Dragons. These activities are based on teacher availability and popularity amongst students.

Chess



SYDNEY
ACADEMY OF CHESS Est 1998

(02) 9745 1170
info@sydneyacademyofchess.com.au

Chess can help students improve their concentration, problem-solving, decision-making, and sense of responsibility. Studies show that chess-playing students demonstrate increased aptitude for concentration, patience, perseverance, and analytical and logical skills. Additionally, chess teaches children resilience through friendly gameplay. Beginners to experts welcome.

ACTIVITIES TO PREPARE YOUR CHILD FOR PRIMARY SCHOOL

Give your child a head start by practising the skills they will use in Kindergarten with them.

TO TRY



Set up a play date for your child to play with a friend.



Check out the local library and let your child choose books to borrow.



Organise a picnic with a packed lunch and encourage your child to open it and eat the food by themselves.



Take a ball to a park to throw, catch and kick together.

ACTIVITIES TO PREPARE YOUR CHILD FOR PRIMARY SCHOOL

Give your child a head start by practising the skills they will use in Kindergarten with them.

TO PRACTISE



Putting on their school shoes and walking in them.



Dressing in their school uniform.



Writing alphabet letters.



Drinking from bubblers.



Using a public toilet with a door lock. And for boys, using a urinal.



Cutting and pasting pictures from a magazine and drawing pictures.



Read Daisy's First Day together





What's in my backpack?

A GUIDE FOR FAMILIES

Library bag



Backpack



School hat



Lunch box



Water bottle



Crunch and Sip



Spare clothes

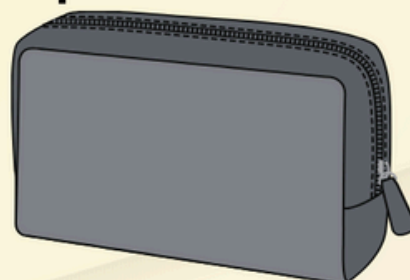



What's in my healthy lunchbox?

A GUIDE FOR FAMILIES

Water bottle

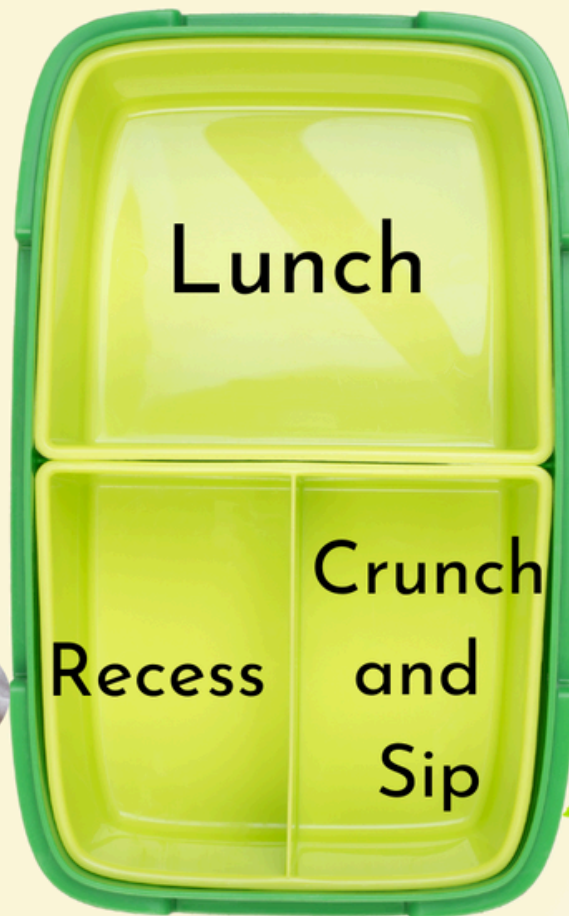

RECESS AND LUNCH IDEAS

- Cut fruit into pieces and put them in a small container. Squeeze some lemon juice on apples or pears to stop them going brown.
- Cut up vegetables such as carrots, celery and cucumber. Put dips or yoghurt in a separate container.
- Make wholemeal muffins and freeze them.
- Try different breads, such as rolls, roti, pita, wholegrain or tortilla wraps.
- If using tomato in a sandwich, slice it thinly and place the slices between other fillings to stop the sandwich from going soggy.
- Cook a little extra dinner and save some for lunch the next day.
- use a sturdy refillable water bottle for drinks at school.
- order lunch from Wil's Canteen using the Spriggy Schools app.



KELLY'S CANTEEN

Our school Canteen has provided delicious, well-priced food and snacks for purchase online or in person. Our Canteen prides itself on a healthy and varied menu. Food can be ordered online through the Spriggy Schools app where you can pick the day, customise your options and add any allergy advice.

Spriggy
Schools



CONNECT WITH OUR SCHOOL

Our wonderful and vibrant Parents and Citizens Association is the formal organisation for parents and members of the community to support our school. The P&C helps us source equipment for the school, organise fundraisers, help with public events (such as fetes and concerts) and encourage parents and citizens to work closely with teachers. As the principal attends P&C meetings, there is an opportunity for families and community members to be involved in school education matters.

Joining the P&C is a great way to actively help the school and be involved in the community.



 www.mpspandc.org.au
 secretary@mpsbandc.org
 [marrickvillepublicschoolpandc](https://www.facebook.com/marrickvillepublicschoolpandc)



THANK YOU

We look forward to welcoming you to our vibrant school community. Starting kindergarten is an exciting time full of new challenges and opportunities for growth. As children navigate this new experience, we will support them to develop important social and emotional skills such as resilience, independence, and perseverance.





116 Chapel St Marrickville NSW 2204



<https://marrickvil-p.schools.nsw.gov.au/>



(02) 9560 2208



marrickvil-p.school@det.nsw.edu.au



<https://www.facebook.com/marrickvillepublicschool>